

## 24B sprockets (1 1/2" Pitch)

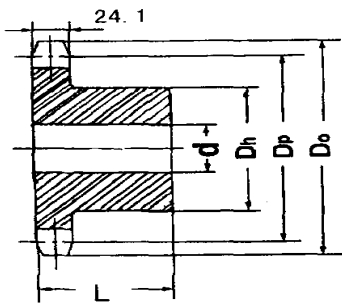

Type B

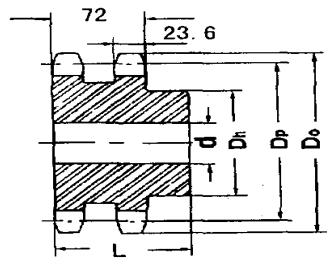

Type B

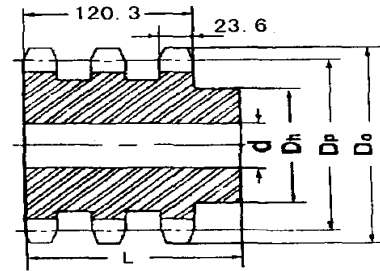

Type B

No of Teeth	Pitch Dia Dp	Outside Dia Do	SINGLE-TYPE			DOUBLE-TYPE			TRIPLE-TYPE		
			Bore d	Hub Dh	L	Bore d	Hub Dh	L	Bore d	Hub Dh	L
8	99.5	115.0	20	58	45	25	58	95	25	58	140
9	111.40	126.4	20	70	45	25	70	95	25	70	140
10	123.29	138.0	20	80	45	25	80	95	25	80	140
11	135.21	150.0	25	90	50	25	90	100	30	90	150
12	147.22	162.0	25	102	50	25	102	100	30	102	150
13	159.18	174.2	25	114	50	25	114	100	30	114	150
14	171.22	186.2	25	128	50	25	128	100	30	128	150
15	183.26	198.2	25	140	50	25	140	100	30	132	150
16	195.30	210.3	25	140	55	30	140	100	30	136	150
17	207.34	222.3	25	140	55	30	150	100	30	140	150
18	219.42	234.3	25	140	55	30	150	100	30	150	150
19	231.49	246.5	25	140	55	30	150	100	30	160	150
20	243.57	258.6	25	140	55	30	160	100	30	160	150
21	255.65	270.6	30	150	60	30	160	100	40	160	150
22	267.73	282.7	30	150	60	30	160	100	40	160	150
23	279.80	294.8	30	150	60	30	160	100	40	160	150
24	291.88	306.8	30	150	60	30	160	100	40	160	150
25	304.00	319.0	30	150	60	30	160	100	40	160	150
26	316.08	331.0	30	160	60	30	160	100	40	160	150
27	328.19	343.2	30	160	60	30	160	100	40	160	150
28	340.27	355.2	30	160	60	30	160	100	40	160	150
29	352.38	367.3	30	160	60	30	160	100	40	160	150
30	364.50	379.5	30	160	60	30	160	100	40	160	150
31	376.62	391.6	30	160	60	40	160	100	40	160	150
32	388.69	403.7	30	160	60	40	160	100	40	160	150
33	400.81	415.8	30	160	60	40	160	100	40	160	150
34	412.93	427.8	30	160	60	40	160	100	40	160	150
35	425.04	440.0	30	160	60	40	160	100	40	160	150
36	437.16	452.0	30	160	60	40	160	100	40	160	150
37	449.27	464.2	30	160	60	40	160	100	40	160	150
38	461.39	476.2	30	160	60	40	160	100	40	160	150
39	473.50	488.5	30	160	60	40	160	100	40	160	150
40	485.62	500.6	30	160	60	40	160	100	40	160	150