

06B sprockets (3/8" Pitch)

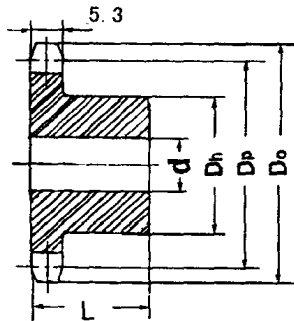

Type B

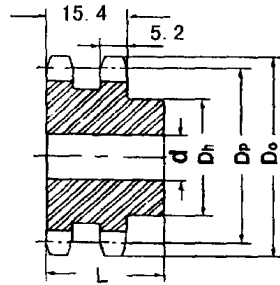

Type B

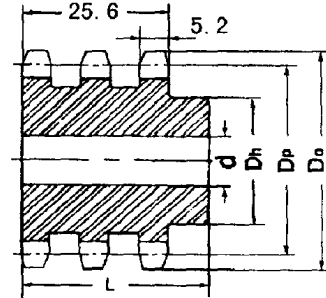

Type B

No of Teeth	Pitch Dia Dp	Outside Dia Do	SINGLE-TYPE			DOUBLE-TYPE			TRIPLE-TYPE		
			Bore d	Hub Dh	L	Bore d	Hub Dh	L	Bore d	Hub Dh	L
8	24.89	28.0	8	15	22	8	15	22	8	15	32
9	27.85	31.0	8	18	22	8	18	22	8	18	32
10	30.82	34.0	8	20	22	8	20	22	10	20	32
11	33.80	37.0	8	22	25	10	22	25	12	22	35
12	36.80	40.0	8	25	25	10	25	25	12	25	35
13	39.80	43.0	10	28	25	10	28	25	12	28	35
14	42.80	46.3	10	31	25	10	31	25	12	31	35
15	45.81	49.3	10	34	25	10	34	25	12	34	35
16	48.82	52.3	10	37	28	12	37	30	12	37	35
17	51.83	55.3	10	40	28	12	40	30	12	40	35
18	54.85	58.3	10	43	28	12	43	30	12	43	35
19	57.87	67.3	10	45	28	12	46	30	12	46	35
20	60.89	64.3	10	46	28	12	49	30	12	49	35
21	63.91	68.0	12	48	28	16	52	30	16	52	40
22	66.93	71.0	12	50	28	16	55	30	16	55	40
23	69.95	73.5	12	52	28	16	58	30	16	58	40
24	72.97	77.0	12	54	28	16	61	30	16	61	40
25	76.00	80.0	12	57	28	16	64	30	16	64	40
26	79.02	83.0	12	60	28	16	67	30	16	67	40
27	82.04	86.0	12	60	28	16	70	30	16	70	40
28	85.07	89.0	12	60	28	16	73	30	16	73	40
29	88.09	92.0	12	60	28	16	76	30	16	76	40
30	91.12	94.7	12	60	28	16	79	30	16	79	40
31	94.15	98.3	14	65	30	16	80	30	16	80	40
32	97.17	101.3	14	65	30	16	80	30	16	80	40
33	100.20	104.3	14	65	30	16	80	30	16	80	40
34	103.23	107.3	14	65	30	16	80	30	16	85	40
35	106.26	110.4	14	65	30	16	80	30	16	85	40
36	109.29	113.4	14	70	30	16	90	30	16	90	40
37	112.32	116.4	14	70	30	16	90	30	16	90	40
38	115.34	119.5	14	70	30	16	90	30	16	90	40
39	118.37	122.5	14	70	30	16	90	30	16	90	40
40	121.40	125.5	14	70	30	16	90	30	16	90	40

06B sprockets (3/8" Pitch)

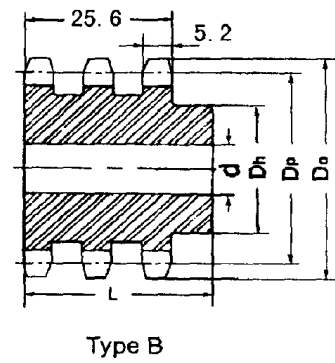
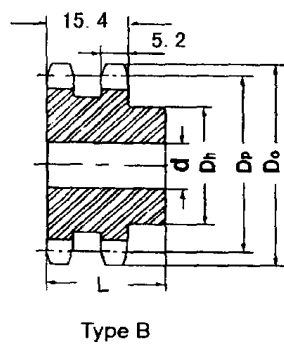
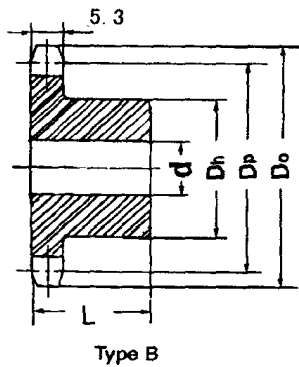

No of Teeth	Pitch Dia Dp	Outside Dia Do	SINGLE-TYPE			DOUBLE-TYPE			TRIPLE-TYPE		
			Bore d	Hub Dh	L	Bore d	Hub Dh	L	Bore d	Hub Dh	L
42	127.46	131.6	16	78	32	20	90	40	20	90	56
45	136.54	140.7	16	78	32	20	90	40	20	90	56
46	139.58	143.7	20	78	32	20	90	40	20	90	56
48	145.64	149.7	20	78	32	20	90	40	20	90	56
50	151.69	155.7	20	78	32	20	90	40	20	90	56
55	166.85	170.8	20	78	32	20	90	40	20	90	56
57	172.91	176.9	20	78	32	20	90	40	25	90	56
60	181.99	186.0	20	78	32	20	90	40	25	90	56
76	230.49	234.9	20	78	32	25	90	40	25	90	56
95	288.08	292.5	25	80	32	25	90	40	25	90	56
114	345.68	349.5	25	80	32	25	90	40	25	90	56

SPROCKETS NZ