

Welded Steel Drag Chain

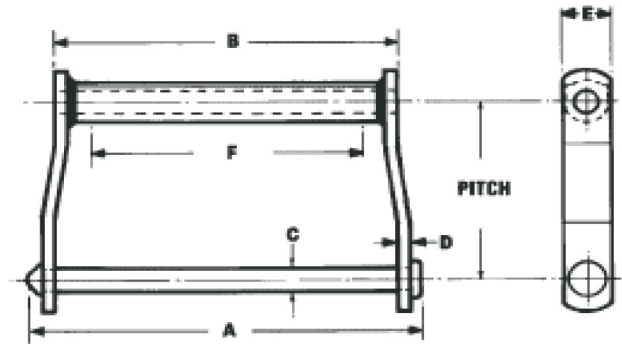

Donghua Chain	Pitch	Overall width	Length of Bearing	Pin Dia.	Side Bar Thickness	Side Bar Height	Maximum Sprocket Face	Ultimate Strength in lbs	Allowable Working Load
		A	B	C	D	E	F		
WD102	5.000	9 ¼	7 ¾	¾	3/8	1 ½	6 3/8	51,000	10,200
WD104	6.000	6 ¾	5 3/8	¾	3/8	1 ½	4 1/8	51,000	10,200
WD110	6.000	11 ¾	10 ¼	¾	3/8	1 ½	9	51,000	10,200
WD112	8.000	11 ¾	10 ¼	¾	3/8	1 ½	9	51,000	10,200
WD113	6.000	12 ½	10 ¼	7/8	½	1 ½	9	67,200	13,400
WD116	8.000	15 ½	14 1/8	¾	3/8	1 ¾	13	51,000	10,200
WD118	8.000	16 5/8	14 7/8	7/8	½	2	13 ¼	70,000	14,000
WD120	6.000	12	10 ¼	7/8	½	2	8 ¾	70,000	14,000
WD122	8.000	12	10 ¼	7/8	½	2	8 ¾	70,000	14,000
WD480	8.000	14 ½	12 ¾	7/8	½	2	11	70,000	14,000

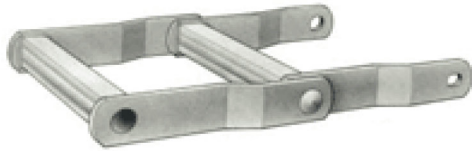